



**Contra-angle handpiece
Repair manual**

Contents

Remove.....1

Inspection.....4

Assembling.....6

● Part 1: Remove contra-angle handpiece

1、 1# head fixing tooling, 2# transmission lever, 3# hexagon wrench, 4# movement rear cover wrench, 5# back nut removal fixture, 6# handle fixing seat.

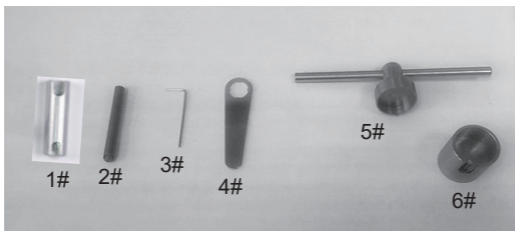

2、 Fix the head with the small side of the opening slot of 4# fixture, align the slot of the handle with 3# fixture and unscrew the handle.

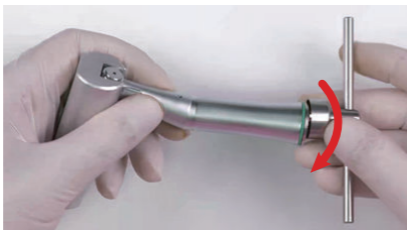

● **Part 1: Remove contra-angle handpiece**

- 3、 Twist 2/3 of the screw counterclockwise with 3# tooling, remove the head and take out the drive shaft.



- 4、 Aim the cylinder at the fiber mouth of the handle with the 6# tool break and use the 2# tool to press out the gearbox.



● **Part 1: Remove contra-angle handpiece**

5、 Use 2# tooling to align the handle bore hole press out gearbox.



6、 Twist out the rear cover of the movement with 4# tooling and take out the movement.

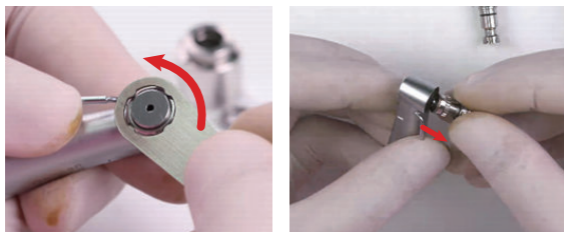

● **Part 2: Inspection**

- 1、 Check whether the surface of core gear and drive shaft gear is damaged and whether the bearing rotates smoothly.

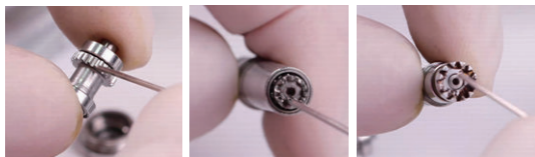

- 2、 Check whether there is foreign matter on the gearbox gear surface and whether the rotation is smooth.

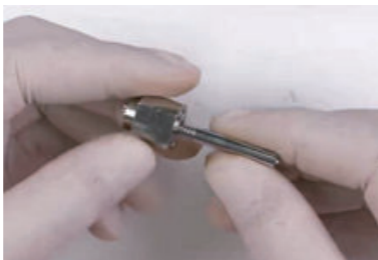

● **Part 2: Inspection**

Bending unit parts need to be replaced in the following cases:

1. gear wear, broken
2. gear and bearing surface rust
2. the bearing rotation card, or the rotation will not move
4. Missing parts

Alternative accessories:

Gearbox assembly/movement assembly/drive shaft assembly

● **Part 3: Assembling contra-angle handpiece**

1、 Install gearbox



2、 Install the handle and pay attention to the optical fiber hole.



● Part 3: Assembling contra-angle handpiece

3、 Twist the handle nut with 5# fixture.



4、 Install the gasket on the movement (note: the front and back of the gasket, with the bump pointing outwards), then assemble the movement into the head, and twist the rear cover of the movement with # 2 tooling.

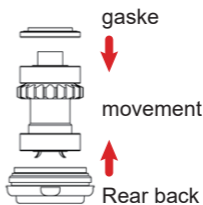

● **Part 3: Assembling contra-angle handpiece**

5、 Mount the drive shaft to the handle and then mount the machine head.

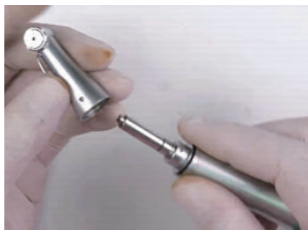

6、 Twist the screw with 2# tooling.



- **Part 3: Assembling contra-angle handpiece**

7、Tighten the nut



8、Complete



Scan and Login website
for more information



Guilin Woodpecker Medical Instrument Co., Ltd.
Information Industrial Park, Guilin National High-Tech
Zone, Guilin, Guangxi, 541004 P. R. China

Tel:

Europe Sales Dept.: +86-773-5873196

North/South America & Oceania Sales Dep.:+86-773-5873198

Asia & Africa Sales Dep.:+86-773-5855350 Fax: +86-773-5822450

E-mail: woodpecker@glwoodpecker.com, sales@glwoodpecker.com

Website: <http://www.glwoodpecker.com>